

"SE 20" - PERSIANA A DOGHE VERTICALI - CARDINI A MURO - LIGHT TECH 20

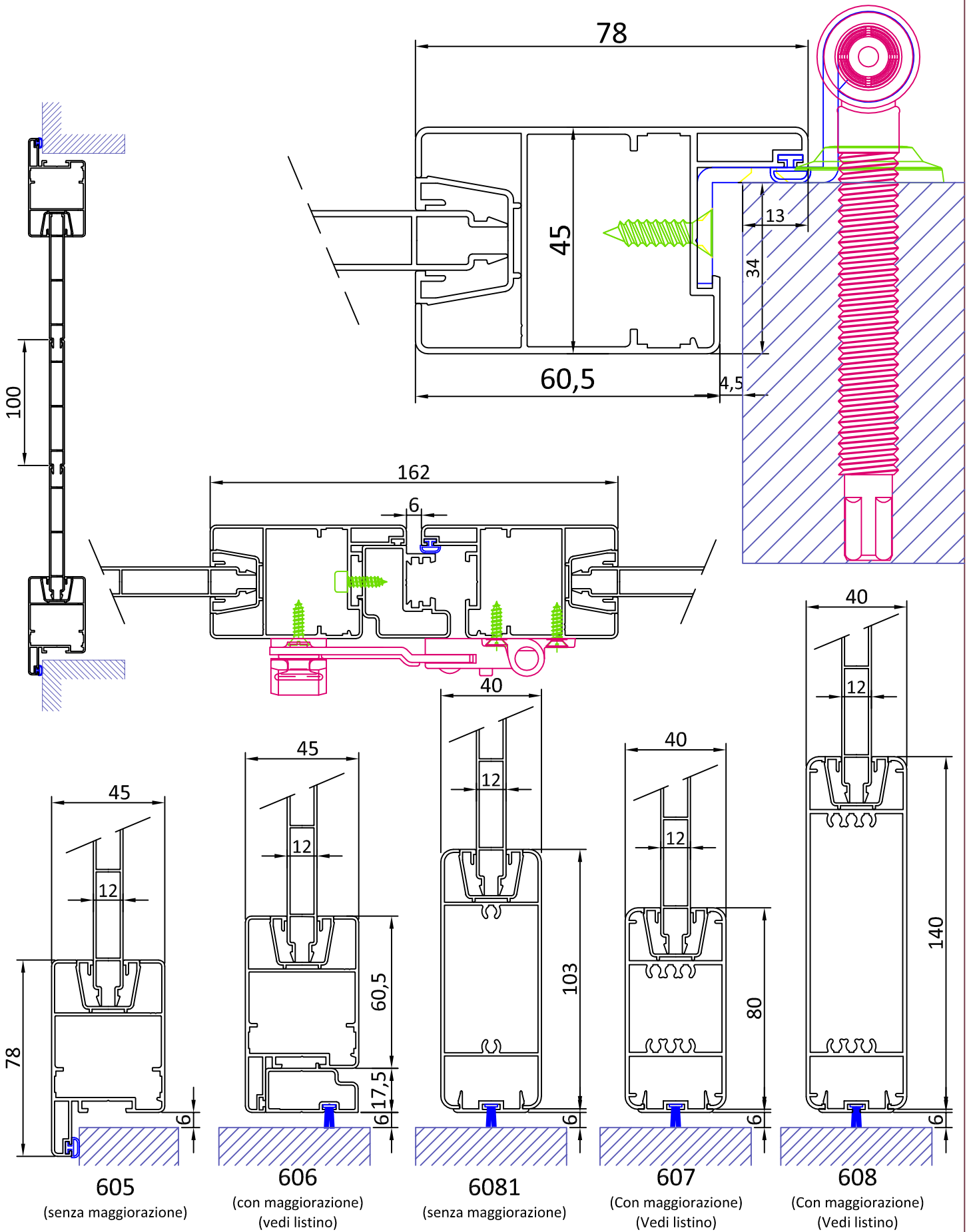

"ME 20" - PERSIANA A DOGHE VERTICALI - TELAIO A SCOMPARSA - EVOLUTION FIX TECH 20

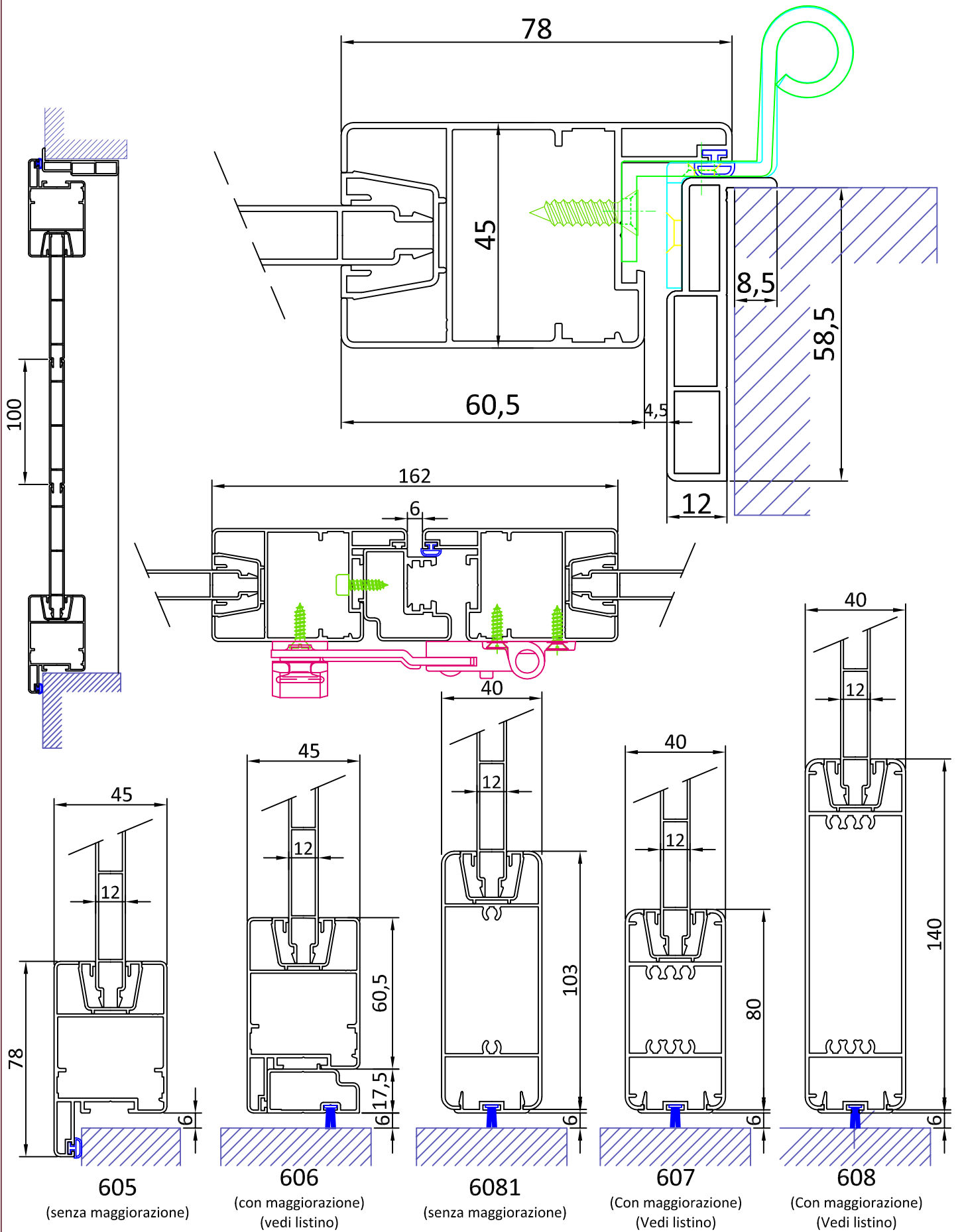

"CE 20" - PERSIANA A DOGHE VERTICALI - TELAIO IN VISTA - COVER TECH 20

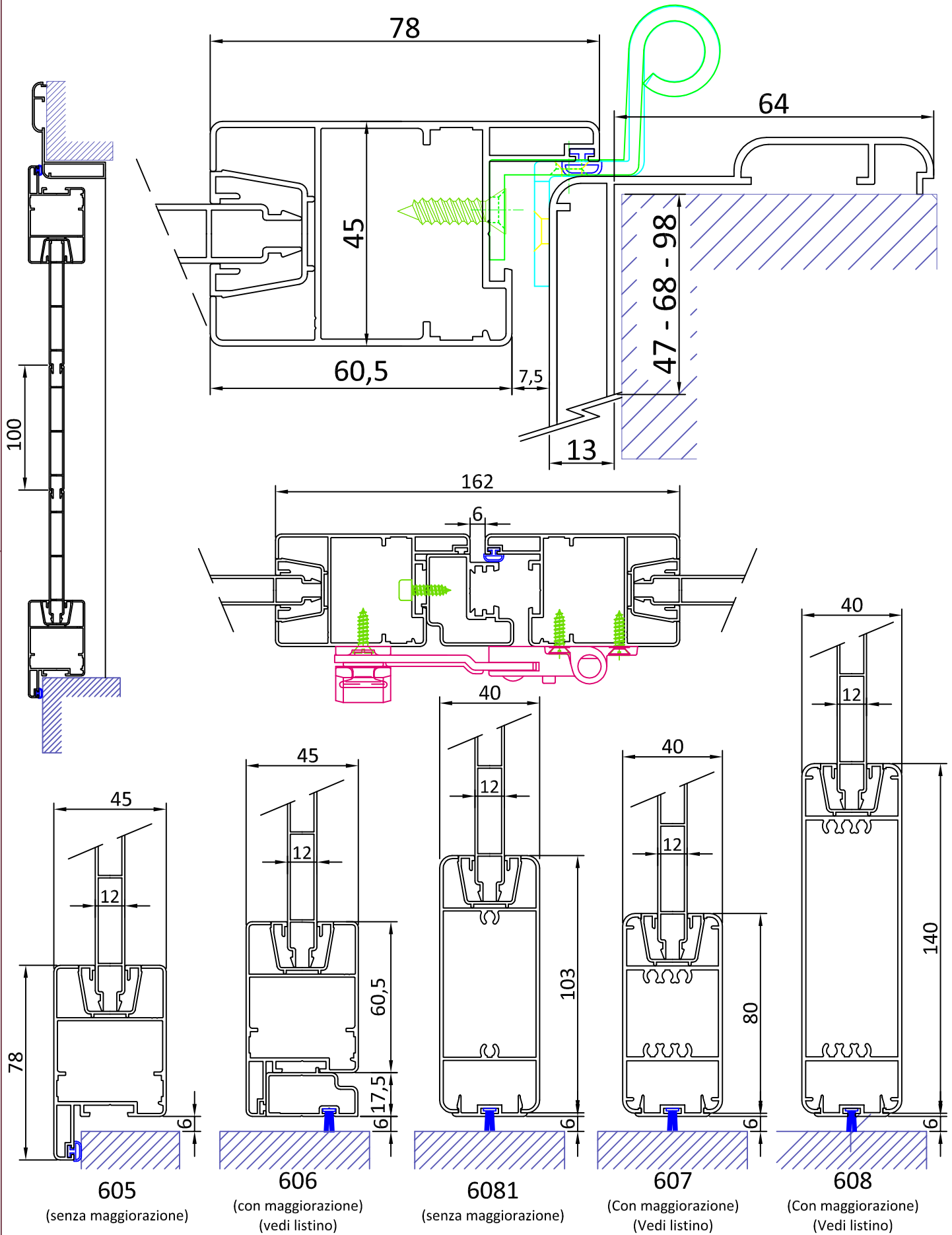

"TE 20" - PERSIANA A DOGHE VERTICALI - TELAIO TRADIZIONALE 25-50-75 MM - FRAME TECH 20
 DISPONIBILE ANCHE NELLA VERSIONE TELAIO RIDOTTO T23 (Vedi "SISTEMI DI FISSAGGIO")

